

# Portsmouth, NH

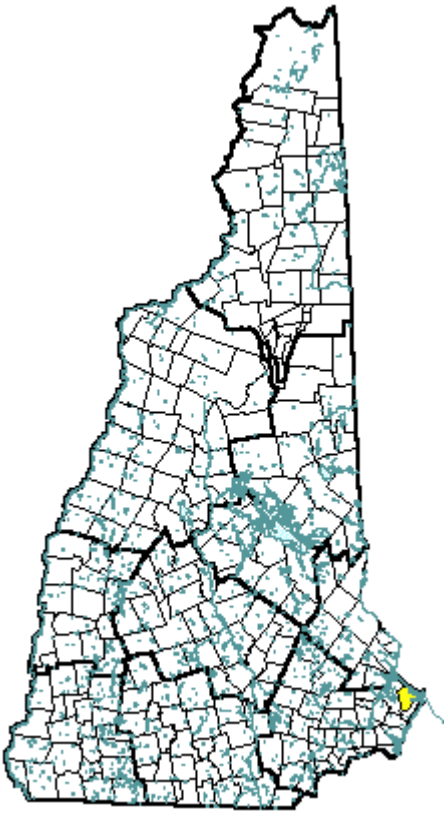

Community Contact	Portsmouth Economic Development Commission Nancy Carmer, Economic Dev. Coordinator 1 Junkins Avenue Portsmouth, NH 03801
Telephone	(603) 431-2000
Fax	(603) 427-1593
E-mail	<a href="mailto:info@lib.cityofportsmouth.com">info@lib.cityofportsmouth.com</a>
Web Site	<a href="http://cityofportsmouth.com">http://cityofportsmouth.com</a>
Municipal Office Hours	Monday through Friday, 8:30 am - 5 pm
County	Rockingham
Tourism Region	Seacoast
Planning Commission	Rockingham
Regional Development	Seacoast Business Alliance Corp.
Election Districts	
US Congress	District 1 (All Wards)
Executive Council	District 3 (All Wards)
State Senate	District 24 (All Wards)
State Representative	District 86 (All Wards)

Incorporated: 1653

**Origin:** First settled in 1630 as Piscataqua, the settlement was soon named Strawberry Banke. The name Portsmouth was adopted in 1653 to honor the colony's founder, John Mason, Captain of the Port in Portsmouth, England. Portsmouth became the New Hampshire province's capitol in 1679. It was home to many famous colonials, such as William Whipple, signer of the Declaration of Independence; Governor John Langdon, first US Senate president; and John Paul Jones, naval hero. Portsmouth was incorporated as a city in 1849. The original Strawberry Banke settlement has been preserved as an example of a colonial American town.

**Population, Year of the First Census Taken:** 4,720 residents in 1790

**Population Trends:** Like many cities, Portsmouth's population growth rate was very low over the last five decades. Population increased by a total of 1,954 residents, going from 18,830 in 1950 to 20,784 in 2000. Population in Portsmouth declined over three decades; decennial growth ranged from a 20 percent decrease between 1990-2000 to a 43 percent increase between 1950-1960. The 2003 Census estimate for Portsmouth was 21,002 residents, which ranked 12th among New Hampshire's incorporated cities and towns.

**Population Density, 2003:** 1,333.4 persons per square mile of land area, the third highest density. Portsmouth contains 15.7 square miles of land area and 1.1 square miles of inland water area.

**Villages and Place Names:** Atlantic Heights, Bersum Gardens, Christian Shore, Creek Area, Elwyn Park, Meadowbrook, Pannaway Manor, Portsmouth Plains, Wentworth Acres, Haymarket Square, Boynton Park, Sagamore Hill, Strawberry Banke, Brimstone Hill

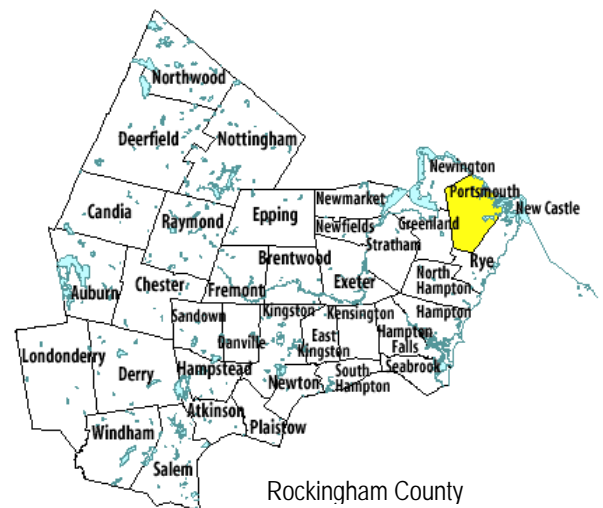

**MUNICIPAL SERVICES**

Type of Government	City Manager & Council
2004 Annual Budget	\$68,672,202
Zoning Ordinance	1927/02
Master Plan	2004
Capital Improvement Plan	Yes
Industrial Plans Reviewed By	Planning Dept.

**Boards and Commissions**

Elected:	City Council; School Board; Police Commission
Appointed:	Planning Board; Conservation Commission; Library Trustees; Historic District Commission; Economic Development Commission; Board of Appeals

Public Library      Portsmouth Athenaeum; Portsmouth Public

**EMERGENCY SERVICES**

Police Department	Full-time
Fire Department	Full-time
Town Fire Insurance Rating	4
Emergency Medical Service	Municipal & commercial

**Nearest Hospital(s):**

**Portsmouth Regional, Portsmouth**

Distance: Local      Staffed Beds: 165

**UTILITIES**

Electric Supplier	PSNH
Natural Gas Supplier	Northern Utilities
Water Supplier	Portsmouth Water Department

Sanitation	Municipal
Municipal Wastewater Treatment Plant	Yes
Solid Waste Disposal	
Curbside Trash Pickup	Municipal
Pay-As-You-Throw Program	No
Recycling Program	Mandatory

Telephone Company	Verizon
Cellular Telephone Access	Yes
Cable Television Access	Yes
High Speed Internet Service:	
Business	Yes
Residential	Yes

**PROPERTY TAXES**

2003 Total Tax Rate (per \$1000)	\$17.74
2003 Equalization Ratio	92.9
2003 Full Value Tax Rate (per \$1000)	\$16.09
2003 Percent of Property Valuation by Type	
Residential Land and Buildings	57.9%
Commercial Land and Buildings	38.1%
Other Property including Utilities	4.1%

**HOUSING**

2002 Total Housing Units	10,254
2002 Single-Family Units	4,746
Building Permits Issued	27
2002 Multi-Family Units	5,229
Building Permits Issued	3
2002 Manufactured Housing Units	279

**DEMOGRAPHICS**

Total Population	Community	County
2003	21,002	290,102
2000	20,784	277,359
1990	25,925	245,845
1980	26,254	190,345
1970	25,717	138,951

**Census 2000 Demographics**

Population by Gender			
Male	10,099	Female	10,685

**Population by Age Group**

Under age 5	1,009
Age 5 to 19	2,864
Age 20 to 34	5,189
Age 35 to 54	6,476
Age 55 to 64	1,862
Age 65 and over	3,384
Median Age	38.5 years

**Educational Attainment, population 25 years and over**

High school graduate or higher	91.4%
Bachelor's degree or higher	41.9%

**ANNUAL INCOME, 1999**

(Census 2000)

Per capita income	\$27,540
Median 4-person family income	\$59,630
Median household income	\$45,195

**Median Earnings, full-time, year-round workers**

Male	\$41,966
Female	\$29,024

**Families below the poverty level**

6.4%

**LABOR FORCE**

Annual Average	1993	2003
Civilian labor force	10,154	10,927
Employed	9,576	10,429
Unemployed	578	498
Unemployment rate	5.7%	4.6%

**EMPLOYMENT & WAGES**

1993      2003

<b>Goods Producing Industries</b>			
Average Employment	1,461	2,964	
Average Weekly Wage	\$540	\$900	
<b>Service Providing Industries</b>			
Average Employment	15,785	22,538	
Average Weekly Wage	\$471	\$837	
<b>Total Private Industry</b>			
Average Employment	17,246	25,502	
Average Weekly Wage	\$477	\$844	
<b>Government (Federal, State, and Local)</b>			
Average Employment	1,616	1,786	
Average Weekly Wage	\$573	\$811	
<b>Total, Private Industry plus Government</b>			
Average Employment	18,861	27,288	
Average Weekly Wage	\$485	\$842	

n = indicates that data does not meet disclosure standards

## EDUCATION AND CHILD CARE

Schools students attend: **Portsmouth operates grades K-12** District: **SAU 52**  
 Career Technology Center(s): **Portsmouth High School** Region: **19**

Educational Facilities	Elementary	Middle/Junior High	High School	Private/Parochial
Number of Schools	4	1	1	1
Grade Levels	P K 1-5	6-8	9-12	K-8
Total Enrollment	1,036	550	1,038	n/a

NH Licensed Child Care Facilities, 2003: Total Facilities: **18** Total Capacity: **1,029**

Nearest Community/Technical College: **Stratham**  
 Nearest Colleges or Universities: **McIntosh; University of NH**

LARGEST EMPLOYERS	PRODUCT/SERVICE	EMPLOYEES	ESTABLISHED
Liberty Mutual Insurance	Insurance	1,800	1969
HCA Hospital	Health care	1,040	1987
City of Portsmouth	Municipal services	881	
Demoulas Market Basket	Supermarket	425	
Lonza Biologics	Biotechnology	390	
Erie Scientific/Sybron Lab Products	Laboratory equipment	310	1978
Pan Am Airlines	Airline	300	
US Dept of State National Passport Center	Passport services	259	
Shaws	Supermarket	226	
US Dept of State National Visa Center	Visa services	215	

## TRANSPORTATION

Road Access	Federal Routes	1, 4
	State Routes	1A, 33
Nearest Interstate, Exit		I-95, Exit 3-7
	Distance	Local access
Railroad		Boston & Maine
Public Transportation		Yes
Nearest Airport		Pease
	Runway	11,321 feet
	Lighted? Yes	Navigational Aids? Yes
Nearest Commercial Airport		Pease
	Distance	Local
Driving distance to select cities:		
	Manchester, NH	44 miles
	Portland, Maine	52 miles
	Boston, Mass.	56 miles
	New York City, NY	264 miles
	Montreal, Quebec	300 miles

## COMMUTING TO WORK

(Census 2000)

Workers 16 years and over	
Drove alone, car/truck/van%	80.5%
Carpooled, car/truck/van	6.4%
Public transportation	1.5%
Walked	4.9%
Other means	1.3%
Worked at home	5.4%
Mean Travel Time to Work	21.5 minutes
Percent of Working Residents:	
Working in community of residence	51%
Commuting to another NH community	33%
Commuting out-of-state	16%

## RECREATION, ATTRACTIONS, AND EVENTS

X	Municipal Parks
X	YMCA/YWCA
	Boys Club/Girls Club
X	Golf Courses
X	Swimming: Indoor Facility
X	Swimming: Outdoor Facility
X	Tennis Courts: Indoor Facility
X	Tennis Courts: Outdoor Facility
	Ice Skating Rink: Indoor Facility
X	Bowling Facilities
X	Museums
X	Cinemas
X	Performing Arts Facilities
X	Tourist Attractions
X	Youth Organizations (i.e., Scouts, 4-H)
X	Youth Sports: Baseball
X	Youth Sports: Soccer
X	Youth Sports: Football
X	Youth Sports: Basketball
X	Youth Sports: Hockey
	Campgrounds
X	Fishing/Hunting
X	Boating/Marinas
	Snowmobile Trails
X	Bicycle Trails
X	Cross Country Skiing
	Beach or Waterfront Recreation Area
	Nearest Ski Area(s): <b>Gunstock</b>
	Other: <b>Strawberry Banke; Harbor &amp; Isles of Shoals Cruises; Historic Homes; Fish Pier; Trolley; Sailing; Kayaking; Music Festival; Shopping</b>

# Pop-Facts: Demographic Quick Facts

Area(s): Radius 1.0, Radius 3.0, Radius 5.0

11 JEWELL CT  
PORTSMOUTH, NH 03801-4990

Latitude: 43.069270  
Longitude: -70.770670

Description	Radius 1.0	Pct.	Radius 3.0	Pct.	Radius 5.0	Pct.
<b>Population</b>						
2009 Projection	10,846		28,902		43,976	
2004 Estimate	10,590		27,977		41,943	
2000 Census	10,430		27,388		40,452	
1990 Census	10,663		32,365		44,497	
Growth 1990 - 2000	-2.18%		-15.38%		-9.09%	
<b>Households</b>						
2009 Projection	5,832		14,012		20,451	
2004 Estimate	5,511		13,205		19,057	
2000 Census	5,276		12,629		18,015	
1990 Census	4,917		12,723		17,417	
Growth 1990 - 2000	7.30%		-0.74%		3.44%	
<b>2004 Est. Population by Single Classification Race</b>						
White Alone	10,099	95.36%	26,332	94.12%	39,760	94.80%
Black or African American Alone	176	1.66%	562	2.01%	672	1.60%
American Indian and Alaska Native Alone	23	0.22%	48	0.17%	63	0.15%
Asian Alone	135	1.28%	555	1.98%	832	1.98%
Native Hawaiian and Other Pacific Islander Alone	7	0.07%	10	0.04%	11	0.03%
Some Other Race Alone	20	0.19%	83	0.30%	103	0.25%
Two or More Races	130	1.22%	386	1.38%	502	1.20%
<b>2004 Est. Population Hispanic or Latino</b>						
Hispanic or Latino	118	1.12%	383	1.37%	508	1.21%
Not Hispanic or Latino	10,472	98.88%	27,594	98.63%	41,435	98.79%
<b>2004 Tenure of Occupied Housing Units*</b>						
Owner Occupied	2,482	45.03%	6,986	52.90%	11,473	60.20%
Renter Occupied	3,029	54.97%	6,220	47.10%	7,584	39.80%
<b>2004 Average Household Size</b>						
	1.85		2.07		2.16	
<b>2004 Est. Households by Household Income</b>						
Income Less than \$15,000	883	16.03%	1,691	12.81%	2,183	11.46%
Income \$15,000 - \$24,999	576	10.45%	1,293	9.79%	1,738	9.12%
Income \$25,000 - \$34,999	594	10.77%	1,561	11.82%	2,076	10.89%
Income \$35,000 - \$49,999	758	13.75%	1,919	14.53%	2,643	13.87%



# Pop-Facts: Demographic Quick Facts

**Area(s):** Radius 1.0, Radius 3.0, Radius 5.0

11 JEWELL CT  
PORTSMOUTH, NH 03801-4990

Latitude: 43.069270  
Longitude: -70.770670

Description	Radius 1.0	Pct.	Radius 3.0	Pct.	Radius 5.0	Pct.
Income \$50,000 - \$74,999	1,067	19.37%	2,623	19.86%	3,882	20.37%
Income \$75,000 - \$99,999	766	13.89%	1,809	13.70%	2,767	14.52%
Income \$100,000 - \$149,999	547	9.93%	1,398	10.59%	2,267	11.89%
Income \$150,000 - \$249,999	228	4.14%	631	4.78%	1,059	5.56%
Income \$250,000 - \$499,999	64	1.16%	158	1.20%	259	1.36%
Income \$500,000 and over	28	0.50%	122	0.92%	184	0.96%
<b>2004 Est. Average Household Income</b>	\$63,637		\$68,260		\$72,351	
<b>2004 Est. Median Household Income</b>	\$48,893		\$51,324		\$55,727	
<b>2004 Est. Per Capita Income</b>	\$33,663		\$32,737		\$33,255	

\*In contrast to Claritas Demographic Estimates, "smoothed" data items are Census 2000 tables made consistent with current year estimated and 5 year projected base counts.



# Retail Trade Potential

Area(s): Radius 1.0, Radius 3.0, Radius 5.0

11 JEWELL CT  
PORTSMOUTH, NH 03801-4990

Latitude: 43.069270  
Longitude: -70.770670

Description	Radius 1.0	Radius 3.0	Radius 5.0
Total Retail Sales	\$287,561,997	\$621,971,859	\$873,166,052
Apparel & Accessory Stores	\$14,279,390	\$33,355,383	\$48,090,929
Automotive Dealers	\$54,232,450	\$116,717,029	\$163,824,914
Automotive & Home Supply Stores	\$1,866,415	\$3,994,170	\$5,559,744
Drug & Proprietary Stores	\$9,705,594	\$21,472,497	\$30,386,415
Eating & Drinking Places	\$24,287,861	\$57,757,391	\$83,413,123
Food Stores	\$46,375,885	\$101,467,211	\$142,751,191
Furniture & Home Furnishing Stores	\$6,138,545	\$14,579,039	\$20,977,925
Home Appliance, Radio, & T.V. Stores	\$11,448,525	\$22,339,441	\$30,298,473
Gasoline Service Stations	\$13,700,883	\$31,433,252	\$44,758,334
General Merchandise	\$51,957,768	\$100,852,448	\$136,537,921
Department Stores (including Leased Depts.)	\$28,609,601	\$55,828,027	\$75,711,429
Hardware, Lumber & Garden Stores	\$17,470,620	\$37,737,393	\$52,920,997



# Portsmouth Traffic Counts 1996-2000

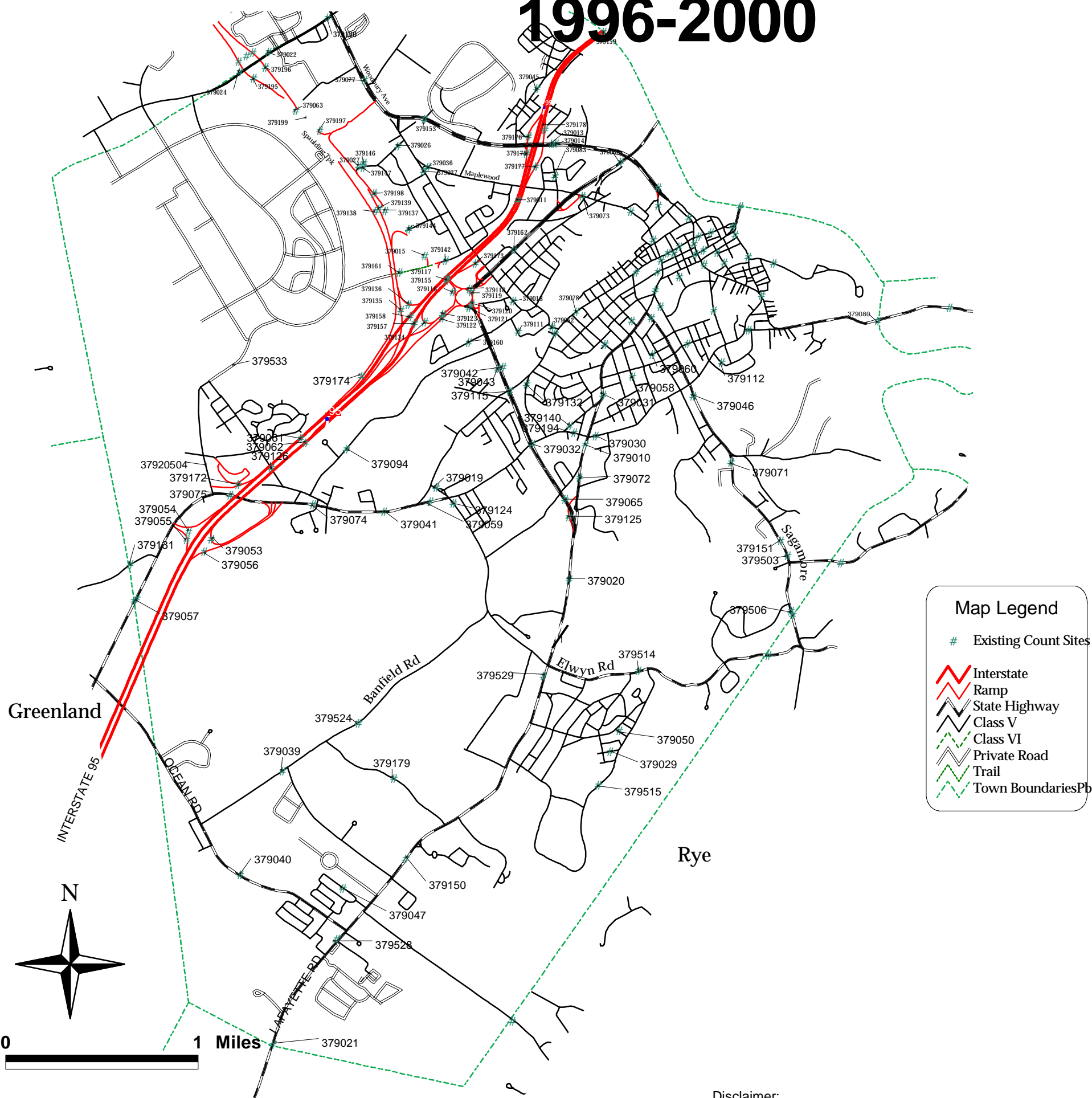

**Disclaimer:**  
 This map is intended for planning purposes only. Comments regarding errors or omissions in the location of the features or attributes of the features are welcome and encouraged, and should be directed to the Rockingham Planning Commission.

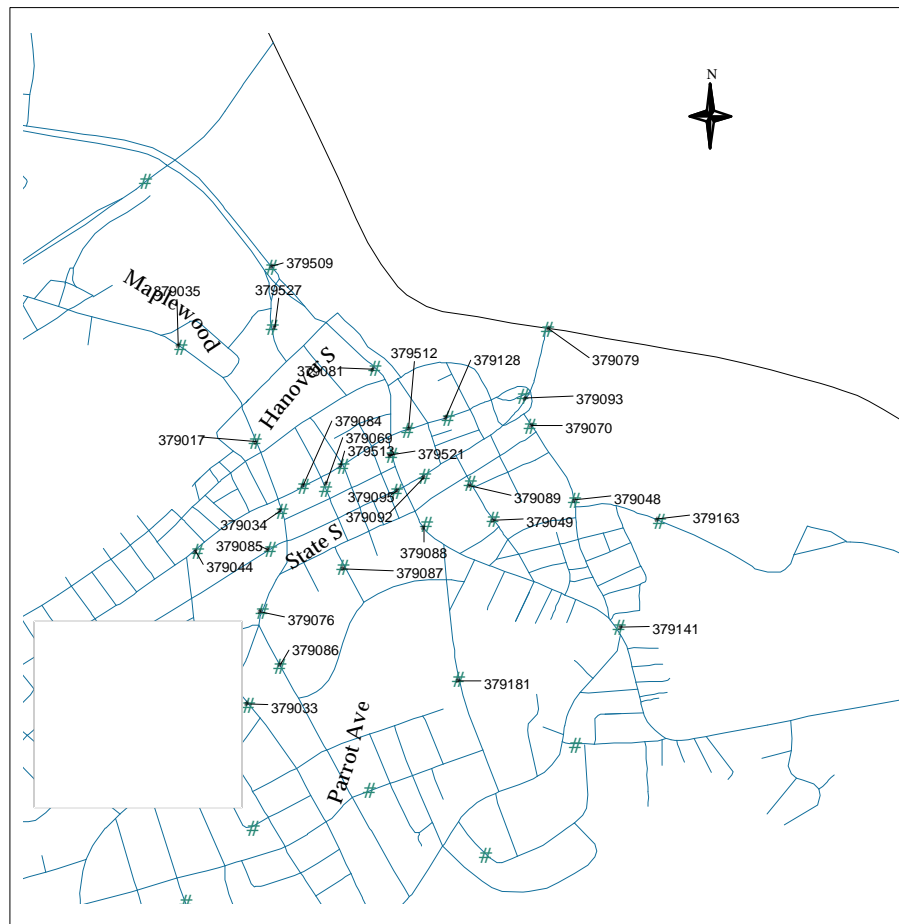
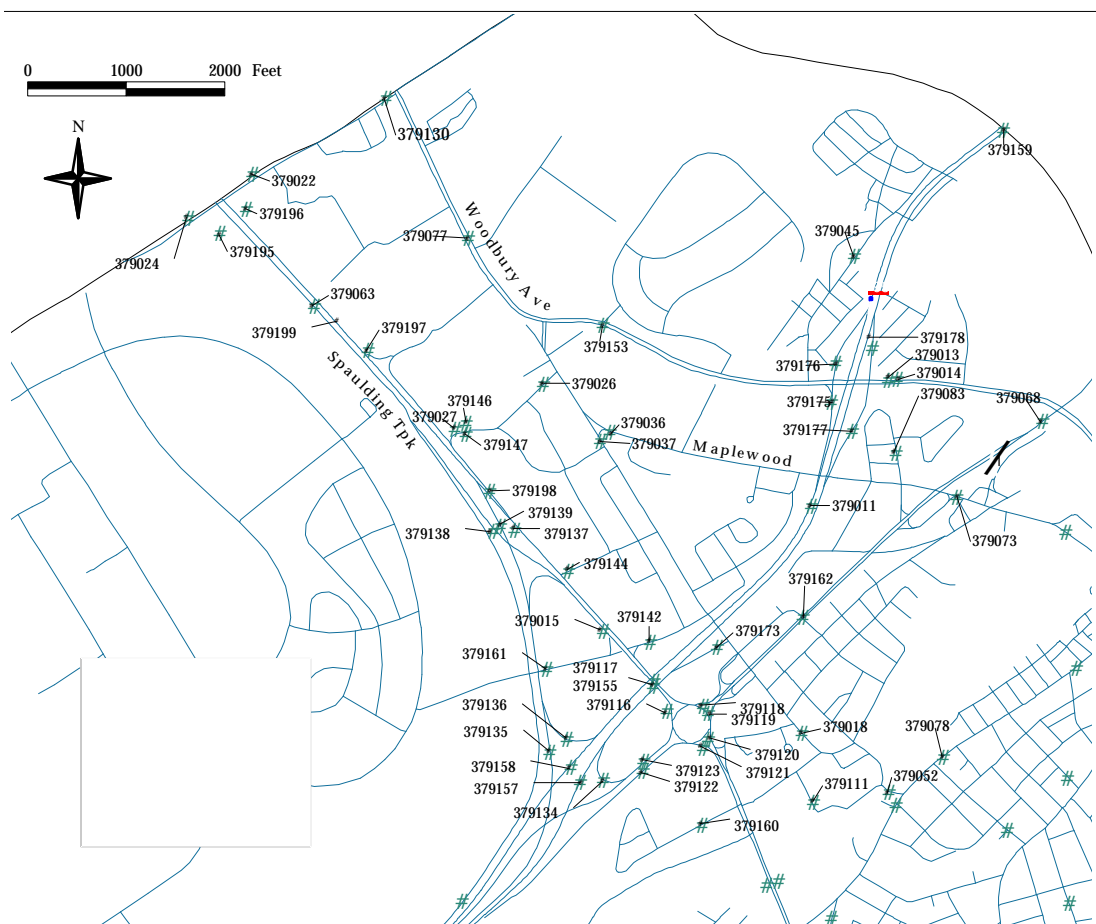

# Portsmouth Traffic Counts

Site_code	2000	1999	1998	1997	1996	Location
379112	none	none	none	150	none	
379115	10311	none	8400	none	none	ISLINGTON STREET OVER US 1 BYPASS
379116	none	none	none	none	none	
379117	none	12000	13000	none	none	TRAFFIC CIRCLE NORTH LEG OUT (US 4 & NH 16)
379118	none	12000	15000	none	none	TRAFFIC CIRCLE EAST LEG IN (US 1 BYPASS)
379119	none	12000	12000	none	none	TRAFFIC CIRCLE EAST LEG OUT (US 1 BYPASS)
379120	none	12000	13000	none	none	TRAFFIC CIRCLE SOUTH LEG IN (US 1 BYPASS)
379121	none	11000	DOT	none	none	TRAFFIC CIRCLE SOUTH LEG OUT (US 1 BYPASS)
379122	none	none	5300	none	none	
379123	none	none	5600	none	none	
379124	none	none	11000	none	none	PEVERLY HILL ROAD SOUTH OF NH 101
379125	none	3100	none	none	none	US 1 SB OVERPASS AT US 1 BYPASS
379126	1897	none	2700	none	none	SHERBURNE ROAD AT I-95 OVERPASS
379127	1502	none	none	1500	none	NEW CASTLE ROAD EAST OF SOUTH STREET (EB-WB) (81379182-379183)
379128	none	5300	none	none	none	DANIEL STREET WEST OF CHAPEL STREET
379130	none	none	5600	none	none	GOSLING ROAD WEST OF WOODBURY AVENUE
379131	2701	none	none	none	1500	OLD NH 101 AT GREENLAND TL
379132	1799	none	none	1600	none	SPINNEY ROAD SOUTH OF ISLINGTON STREET (SB-NB) (81379192-3791
379134	none	none	5400	none	none	
379135	none	none	13000	none	none	RAMP TO SPAULDING WB FROM I-95 NB
379136	none	none	6000	none	none	I-95 OFF RAMP TO SPAULDING
379137	none	none	none	none	none	
379138	none	none	none	none	none	
379139	none	none	none	none	none	
379140	none	none	2600	none	none	NH 33 WEST OF WARD ST
379141	2518	none	4200	none	none	NH 1B (PLEASANT STREET) AT MILL POND BRIDGE
379142	none	none	1700	none	none	ROCKINGHAM AVE SB-NB NORTH OF SPAULDING TURNPIKE (81379142-37
379144	none	none	750	none	none	FARM LANE SB-NB NORTH OF SPAULDING TURNPIKE (81379144-379145)
379146	none	none	none	none	none	ECHO AVE S OF WOODLAWN
379147	none	none	none	none	none	
379150	none	none	20000	none	none	US 1 NORTH OF DRIVE TO DATA GENERAL
379151	none	none	3800	none	none	NH 1A SB-NB AT SAGAMORE CREEK (81379151-379152)
379153	none	none	17000	none	none	MARKET STREET EXT EB-WB NEAR GRANITE STREET (81379153-379154)
379155	none	64000	60000	59000	54600	
379157	none	none	none	none	none	
379158	none	51000	49000	4700	43400	
379159	none	none	68658	66044	64354	
379160	none	none	590	none	none	COAKLEY ROAD OVER HODGSON BROOK
379161	none	none	none	none	none	
379162	none	none	80	none	none	STARK STREET OVER US 1 BYPASS
379163	none	none	900	none	none	PIERCES ISLAND ROAD OVER LITTLE HARBOR
379172			9600			
379173	none	none	1100	none	none	
379174	none	none	13000	none	none	RAMP FROM SPAULDING TO I-95 SB
379175	none	none	7000	none	none	
379176	none	none	3500	none	none	
379177	none	none	2500	none	none	
379178	none	none	7400	none	none	
379179	none	none	2900	none	none	CONSTITUTION AVE - MIDWAY OF LENGTH
379180	none	none	3500	none	none	CASS ST NORTH OF US 1
379181	none	none	3700	none	none	JUNKINS ST MIDWAY OF LENGTH
379194	5160	none	none	none	none	SOUTH STREET BETWEEN MONROE STREET & SHERIDAN STREET
379195	none	none	none	none	none	ON RAMP TO SPAULDING TPK EB FROM GOSLING
379196	none	none	none	none	none	OFF RAMP FROM SPAULDING WB TO GOSLING
379197	none	none	none	none	none	BRADY AVE RAMP ONTO SPAULDING NB
379198	none	none	none	none	none	OFF RAMP TO ECHO AND BRADY
37920504	7552	none	none	none		PEASE SOUTH ENTRANCE BETWEEN PARK & RIDE & RT33
379503	none	none	7786	none		SAGAMORE ROAD Near Sagamore Bridge
379506	none	none	8247	none		SAGAMORE ROAD Near Rye Town Line
379509	16466	RPC	none	none		MARKET STREET PAST SALT PILE NEAR CHAMBER
379512	none	none	none	none		
379513	none	none	none	none		FLEET ST AT CONGRESS
379514	none	RPC				Elwyn Road - Rye Town Line - Lafayette, N of Har
379515	none	RPC				FW Hartford Drive (Taft Rd - Harding)
379516	none	RPC				Lincoln Ave, N of Richards
379521	none	none	2998 AWC	none		PLEASANT STREET Btwn Market Square & State
379524	none	none	5319 AWC	none		BANFIELD STREET East of Constitution
379527	none	none	6753 AWC	none		RUSSELL AVENUE
379528	none	RPC				RT 1 S OF OCEAN ROAD
379529	none	RPC				RT 1 SOUTH OF PEVERLY HILL RD
379533	5765	none	NONE	none	none	PEASE S ENTRANCE N OF PARK & RIDE